

# Document Scanners

## ScanSnap S1300i



**ScanSnap**  
Color Image Scanner  
S1300i

- Impressive scanning speed (12 ppm / 24 ipm)
- Supports capturing documents for e-mail, printing and for use with Microsoft® Word and Excel
- Business Card scanning software
- Top-class OCR engine
- Seamlessly sync to iPad®/iPhone® and Android™ devices
- Scan your documents to a variety of popular cloud services via the intuitive quickmenu



shaping tomorrow with you

**FUJITSU**

# ScanSnap S1300i

<b>S1300i</b>	<b>10 Sheets</b>	<b>600 dpi</b>	<b>Simplex 12 ppm</b>	<b>Duplex 24 ipm</b>

OPERATES ON BOTH WINDOWS AND MAC OS OPERATING SYSTEMS • OPERATES ON BOTH SINGLE AND DOUBLE SIDED DOCUMENTS

## Stack, Scan. Simple!

The portable ScanSnap S1300i provides Windows and Mac users the tools to be productive and paperless... anywhere – anytime.

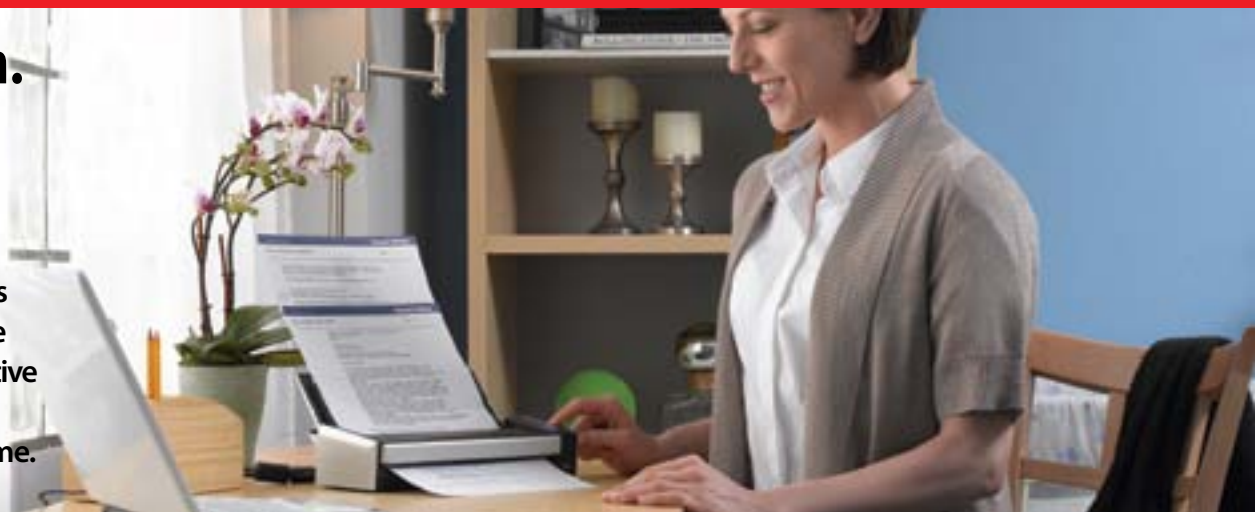

### Simple, Speedy & Compact!

The ScanSnap S1300i is a document scanner for the PC or Mac user capable of scanning up to 12 pages per minute / 24 images per minute. The 10 page ADF can cope with a mixed variety of single or double sided documents ranging in different size and thickness as well as colour or black and white.

#### • Auto deskew and auto orientation



#### • Auto-size detection



#### • Automatic resolution function

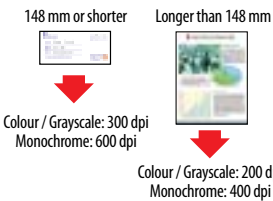

#### • Intelligent auto colour detection



### Efficiently Manages Scanned Documents

- S1300i users can easily locate specific ScanSnap generated PDF and JPEG files by viewing displayed thumbnail images
- Keyword searches can be performed on S1300i generated PDF file text
- The S1300i creates searchable PDF files by performing OCR functions when the linked computer CPU is idling

#### Intelligent Cropping (PC users only)

This feature enables users to easily "cut out" digitised copies of newspaper and magazine articles that they have outlined on the original paper document with a highlight pen.

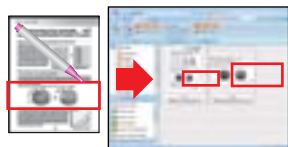

#### Intelligent Indexing

This feature extracts text from sections of scanned images that have been highlighted. This index information can then be attached to PDF files as so called Meta Data.

PDF Management and Search Software  
**Bundled** For PC Users: **ScanSnap Organizer V4.1**

### The S1300i "Quick Menu" Facilitates Intuitive Use

Users just choose what they want to do from the Quick Menu, which appears after a document has been scanned. The S1300i Quick Menu is perfect for everyone, even the complete novice!

#### • Quick Menu for Windows® OS Users



#### • Quick Menu for Mac OS Users



<b>Document received</b> >>	<b>Document scanned</b> >>	<b>Now make your paper productive</b> >>																																								
		<table border="0"> <tr> <td>Scan to Folder</td> <td>&lt;</td> <td>&gt;</td> <td>Scan to PowerPoint® (PC Only)</td> </tr> <tr> <td>Scan to Email</td> <td>&lt;</td> <td>&gt;</td> <td>Scan to Word</td> </tr> <tr> <td>Scan to Print</td> <td>&lt;</td> <td>&gt;</td> <td>Scan to Excel</td> </tr> <tr> <td>Scan to Pictures (PC Only)</td> <td>&lt;</td> <td>&gt;</td> <td>Scan and extract business card data</td> </tr> <tr> <td>Scan to iPhoto (MAC Only)</td> <td>&lt;</td> <td>&gt;</td> <td>Scan to ScanSnap Organizer (PC Only)</td> </tr> <tr> <td>Scan to Evernote</td> <td>&lt;</td> <td>&gt;</td> <td>Scan to Rack2-Filer</td> </tr> <tr> <td>Scan to Google Docs</td> <td>&lt;</td> <td>&gt;</td> <td>Scan to Mobile Device</td> </tr> <tr> <td>Scan to SugarSync</td> <td>&lt;</td> <td>&gt;</td> <td>Scan to Salesforce Chatter</td> </tr> <tr> <td>Scan to SharePoint</td> <td>&lt;</td> <td>&gt;</td> <td></td> </tr> <tr> <td>Scan to Dropbox</td> <td>&lt;</td> <td>&gt;</td> <td></td> </tr> </table>	Scan to Folder	<	>	Scan to PowerPoint® (PC Only)	Scan to Email	<	>	Scan to Word	Scan to Print	<	>	Scan to Excel	Scan to Pictures (PC Only)	<	>	Scan and extract business card data	Scan to iPhoto (MAC Only)	<	>	Scan to ScanSnap Organizer (PC Only)	Scan to Evernote	<	>	Scan to Rack2-Filer	Scan to Google Docs	<	>	Scan to Mobile Device	Scan to SugarSync	<	>	Scan to Salesforce Chatter	Scan to SharePoint	<	>		Scan to Dropbox	<	>	
Scan to Folder	<	>	Scan to PowerPoint® (PC Only)																																							
Scan to Email	<	>	Scan to Word																																							
Scan to Print	<	>	Scan to Excel																																							
Scan to Pictures (PC Only)	<	>	Scan and extract business card data																																							
Scan to iPhoto (MAC Only)	<	>	Scan to ScanSnap Organizer (PC Only)																																							
Scan to Evernote	<	>	Scan to Rack2-Filer																																							
Scan to Google Docs	<	>	Scan to Mobile Device																																							
Scan to SugarSync	<	>	Scan to Salesforce Chatter																																							
Scan to SharePoint	<	>																																								
Scan to Dropbox	<	>																																								

### Generates Microsoft® Word, Excel and PowerPoint® Files

- Editable images can be created by scanning directly to Microsoft® Word, Excel and PowerPoint® files\*
- \* PowerPoint® functionality available for Windows OS only. Generated images and text may vary from the original



Top-class OCR engine

**Bundled** **ABBYY FineReader for ScanSnap™ 4.1**

## Seamless linking to Cloud services

The ScanSnap series scanners come with a standard array of functions for near effortless scanning to Evernote, Google Docs, Salesforce, SugarSync and Dropbox. The S1300i brings significant upgrades to the ScanSnap series entry model for convenient browsing from a computer or smartphone – anywhere, anytime.

### ScanSnap Folder (Windows OS only)

You can now easily scan into your preferred application or cloud service even when no scan interface is available, through the import capability. Browse to the new ScanSnap Folder and hit the blue scan button. The documents are now imported into your application and automatically deleted from the ScanSnap Folder on your local computer!

### ScanSnap welcomes Dropbox

The new S1300i features the latest Quick Menu which includes a new function for saving scanned documents to Dropbox, one of today's leading online file syncing/storage services.

With more cloud services to choose from, ScanSnap customers are sure to find the right application for their documents.

### Efficiently Organises Business Card Information

- Scans large volumes of business cards into digital business card holders
- Enables users to export scanned data into Excel, Outlook, Salesforce and other contact management tools for future reference



Business Card Scanning Software

**Bundled** For PC Users: **CardMinder™ V4.1**  
For Mac Users: **Cardiris™ 4.0 for ScanSnap**

### ScanSnap S1300i Deluxe comes with Rack2-Filer V5.0

- Directly file and organize your digitized documents in virtual binders
- Realistic page flip interface with useful editing functions
- A powerful tool for uniformly managing image data produced by the S1300i and other devices



### Scans to a greater range of mobile devices

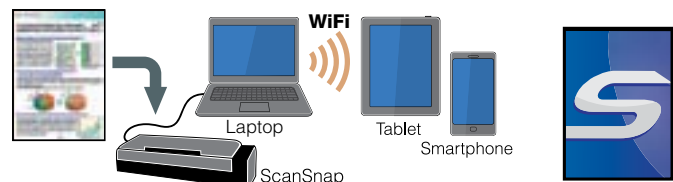

Like all scanners of the ScanSnap series, the S1300i supports wireless scanning to iPad® and iPhone® devices for convenient mobile viewing via the mobile app ScanSnap Connect Application\*, which now comes in a version for Android™ smartphones and tablets.

\* ScanSnap Connect Application is available as a free download from the official application distribution service of the device (e.g., Google Play and Apple App Store). The Wi-Fi of the ScanSnap installed computer must be turned on to use this feature.

# ScanSnap S1300i Specifications



ENERGY STAR® compliant

<b>Product name</b>	<b>ScanSnap S1300i</b>	
<b>Scanner type</b>	ADF (Automatic Document Feeder), duplex scanning	
<b>Scanning modes</b>	Colour, grayscale, monochrome, automatic (colour / grayscale / monochrome detection)	
<b>Image sensor / Multi-feed detection</b>	CIS (Contact Image Sensor) x 2 / Length check	
<b>Light source / Optical resolution</b>	3 Colour LED (Red/Green/Blue) / 600 dpi	
<b>Scanning speed</b> <sup>11</sup> (A4 portrait) AC Adapter	Auto mode <sup>2</sup>	Simplex, duplex 6 ppm
	Normal mode	Colour / grayscale 150 dpi, monochrome 300 dpi, simplex, duplex 12 ppm
	Better mode	Colour / grayscale 200 dpi, monochrome 400 dpi, simplex, duplex 9 ppm
	Best mode	Colour / grayscale 300 dpi, monochrome 600 dpi, simplex, duplex 6 ppm
	Excellent mode	Colour / grayscale 600 dpi, monochrome 1,200 dpi, simplex, duplex 1 ppm
<b>Scanning speed</b> <sup>11</sup> (A4 portrait) USB bus powered <sup>13</sup>	Auto mode <sup>2</sup>	Simplex, duplex 2 ppm
	Normal mode	Colour / grayscale 150 dpi, monochrome 300 dpi, simplex, duplex 4 ppm
	Better mode	Colour / grayscale 200 dpi, monochrome 400 dpi, simplex, duplex 3 ppm
	Best mode	Colour / grayscale 300 dpi, monochrome 600 dpi, simplex, duplex 2 ppm
	Excellent mode	Colour / grayscale 600 dpi, monochrome 1,200 dpi, simplex, duplex 1 ppm
<b>Document size</b>	Normal mode	A4, A5, A6, B5, B6, Business card, Post card, Letter, Legal and Custom sizes (Max : 216 x 360 mm, Min : 50.8 x 50.8 mm) / Automatically recognises document size
	Long paper scanning <sup>4</sup>	863 mm
<b>Paper weight (Thickness), Paper chute capacity</b> <sup>5</sup>	64 to 104.7 g/m <sup>2</sup> , Maximum 10 sheets (A4, 80 g/m <sup>2</sup> )	
<b>Interface</b>	USB 2.0 (USB 1.1 Compatible)	
<b>Power requirement</b>	AC adapter, USB bus power AC 100 to 240V, 50 / 60Hz, 5V / 1A (0.5A x 2 port)	
<b>Power consumption</b>	Power cable connection	During operation: 9W or less, During sleep mode: 2.6W or less
	USB bus power cable connection	During operation: 5W or less, During sleep mode: 2W or less
<b>Operation environment</b>	Temperature : 5 to 35°C (41 to 95°F) / Relative humidity: 20 to 80% (Non-condensing)	
<b>Dimensions (W x D x H)<sup>6</sup>, Device weight</b>	284 x 99 x 77 mm, 1.4kg	
<b>Environment compliance</b>	ENERGY STAR® compliant / RoHS <sup>7</sup>	

- <sup>11</sup> Scanning speeds may vary due to the system environment used.
- <sup>12</sup> Documents measuring approximately 148 mm in length or less are scanned in "Best mode", while other documents are scanned in "Better mode".
- <sup>13</sup> When using the USB bus power cable, the personal computer must have two USB ports: one for power feeding, the other for USB cable connection.
- <sup>14</sup> ScanSnap S1300i is capable of scanning documents that exceed A4 size in length. It supports the scanning of longer documents in all modes, except for "Excellent mode".
- <sup>15</sup> Maximum capacity varies, depending upon paper weight.
- <sup>16</sup> When chuter is closed.
- <sup>17</sup> PFI LIMITED, a Fujitsu company, has determined that this product meets RoHS requirements (2002 / 95 / EC).

System requirements for Windows	Windows® 7 (32bit / 64bit)	Windows Vista™ (32bit / 64bit) <sup>11</sup>	Windows® XP (32bit) <sup>12</sup>	
<b>Driver / Applications</b> <sup>3</sup>	ScanSnap Manager V5.1	Supported	Supported	
	ScanSnap Organizer V4.1 <sup>2</sup>	Supported	Supported	
	CardMinder™ V4.1	Supported	Supported	
	ABBYY FineReader for ScanSnap™ 4.1	Supported	Supported	
	Scan to Microsoft® SharePoint 3.4	Supported	Supported	
	Evernote for Win 4.4	Supported	Supported	
<b>Hardware requirements</b> <sup>4</sup>	CPU <sup>5</sup>	Intel® Pentium® 4 1.8GHz or higher (recommended: Intel® Core™ 2 Duo 2.2GHz or higher)		
	Memory capacity <sup>5</sup>	64bit: 2 GB or more 32bit: 1 GB or more	512 MB or more (recommended : 1 GB or more)	
	Display	800 x 600 pixels or more		
	Disk capacity <sup>6</sup>	2,290 MB free hard disc space for installation		
	DVD-ROM drive	Required for installation		
	USB port <sup>5,7</sup>	USB 3.0 / USB 2.0 / USB 1.1		

- <sup>11</sup> For use with Service Pack 1 or higher
- <sup>12</sup> For use with Service Pack 3 or higher. Compatible with Windows® XP Professional / Home Edition
- <sup>3</sup> Please refer to the ScanSnap Web site for latest support information.
- <sup>4</sup> The ScanSnap device may not work if the connected computer does not meet this requirement.
- <sup>5</sup> Scanning speeds may drop if recommended CPU, memory capacity and USB 1.1 requirements are not met.
- <sup>6</sup> Microsoft .NET Framework 3.5 SP1 will be installed (requires 500 MB of disk space) together with either ScanSnap Manager or ScanSnap Organizer for systems that do not have .NET Framework 3.5 SP1 installed.
- <sup>7</sup> ScanSnap operates on both USB 2.0 and USB 3.0 without any difference in performance.

System requirements may change depending on the duration of support and the support policy of the companies that make the software listed in the table above.

System requirements for Mac OS	Mac OS X v10.7	Mac OS X v10.6 <sup>11</sup>	Mac OS X v10.5 <sup>12</sup>	
<b>Driver / Applications</b> <sup>3</sup>	ScanSnap Manager V3.2	Supported	Supported	
	Cardiris™ 4.0 for ScanSnap	Supported	Supported	
	ABBYY FineReader for ScanSnap™ 4.1	Supported	Supported	
	Evernote for Mac 2.2	Supported <sup>4</sup>	Supported <sup>5</sup>	
<b>Hardware requirements</b> <sup>6</sup>	CPU <sup>7</sup>	Intel® Core™ 2 Duo (recommended: Intel® Core™ 2 Duo 2.4 GHz or higher)		
	Memory capacity <sup>7</sup>	2 GB or more	1 GB or more	512 MB or more (recommended : 1 GB or more)
	Display	1,024 x 768 pixels or more		
	Disk capacity	1,555 MB free hard disc space for installation		
	DVD-ROM drive	Required for installation		
	USB port <sup>7</sup>	USB 2.0 / USB 1.1		

- <sup>11</sup> Mac OS X v10.6.6 or later recommended.
- <sup>12</sup> Mac OS X v10.5.8 recommended.
- <sup>3</sup> Please refer to the ScanSnap Web site for latest support information.
- <sup>4</sup> Download and install the latest version of Evernote, which is available from the official website of Evernote Corp.
- <sup>5</sup> Mac OS X v10.5.8 only.
- <sup>6</sup> The ScanSnap device may not work if the connected computer does not meet this requirement.
- <sup>7</sup> Scanning speeds may drop if recommended CPU, memory capacity and USB 1.1 requirements are not met.
- System requirements may change depending on the duration of support and the support policy of the companies that make the software listed in the table above.

Software	Windows®	Mac OS
<b>Driver</b> <sup>11,12</sup>	ScanSnap Manager V5.1	ScanSnap Manager V3.2
<b>Software Applications</b>	ScanSnap Organizer V4.1	-
	Evernote for Win 4.4	Evernote for Mac 2.2
	CardMinder™ V4.1	Cardiris™ 4.0 for ScanSnap
	Scan to Microsoft® SharePoint® 3.4	-
		ABBYY FineReader for ScanSnap™ 4.1

- <sup>11</sup> TWAIN or ISIS™ applications cannot be used directly.
- <sup>12</sup> "One touch" image file (JPEG, PDF and searchable PDF) generation. These functions are operable with ScanSnap Manager V5.0 (ScanSnap specific driver).

Consumables and Options	Part number	Remarks
<b>Consumable Kit</b>	CON-3541-010A	1 x Pick Roller; 2 x Pad Assy; total max. lifetime 100,000 documents or 1 year
<b>ScanSnap Cleaning Kit</b>	SC-CLE-SS	24 cleaning fluid impregnated wipes (EAN 5032140200205)
<b>ScanSnap S300 Soft Case</b> <sup>1</sup>	PA03541-0004	Intended for ScanSnap S1300i, S1300, S300, S300M and included items

- <sup>11</sup> This product has been especially designed for storing and carrying ScanSnap S1300i / S1300 / S300 / S300M. Please note that this product is not guaranteed to withstand damage by excessive shock or external pressure.

All names, manufacturer names, brand and product designations are subject to special trademark rights and are manufacturer's trademarks and/or registered brands of their respective owners. All indications are non-binding. Technical data is subject to change without prior notification. Apple, iPad, iPhone, iPod touch and iTunes are trademarks of Apple Inc., registered in the U.S. and other countries. App Store is a service mark of Apple Inc.

**PFI Imaging Solutions Europe Limited**  
 Hayes Park Central  
 Hayes End Road, Hayes  
 Middlesex UB4 8FE  
 England  
 Tel: (+44-(0)20) 8573 4444  
 Fax: (+44-(0)20) 8573 2643

**PFI Imaging Solutions GmbH**  
 Frankfurter Ring 211  
 80807 Munich  
 Germany  
 Tel: (+49-(0)89) 32378-0  
 Fax: (+49-(0)89) 32378-100

**PFI Imaging Solutions S.p.A.**  
 Via Nazario Sauro, 38  
 20099 Sesto San Giovanni (MI)  
 Italy  
 Tel: (+39) 0226294.1  
 Fax: (+39) 0226294.201

[www.ScanSnapit.com](http://www.ScanSnapit.com)